

- | | |
|--|-----------------------|
| Applied For Substation Site Boundary | Residence |
| Rejected Substation Site Boundary | Surface Well Site |
| Applied For Substation Site Boundary Node | Railway |
| Rejected Substation Site Boundary Node | Primary Highway |
| ATCO Transmission Line Proposed Route Option A | Road |
| ATCO Transmission Line Proposed Route Option C | Existing Easement R/W |
| ATCO Transmission Line Proposed Route Variation C2 | |
| Applied For Route Option A Node | |
| Applied For Route Option C Node | |

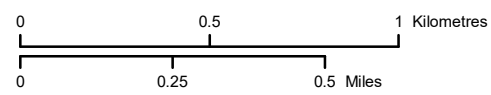

NOTES:
 - Only facilities in the vicinity of the project are shown.
 - Several routes are shown, but only one will be built.

This map is the property of ATCO. This map is not intended to be used in place of Alberta One Call.
 Always practice extreme caution when near power lines!

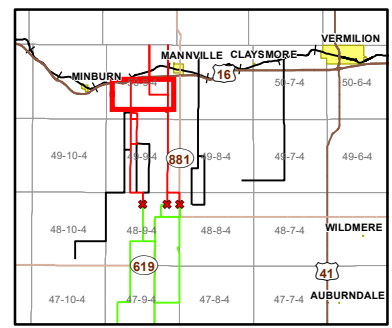

KEY MAP



Buffalo Creek Transmission Project

2007S DRURY SUBSTATION
 SITE MOSAIC MAP

June 2021

RS-7L333 - N8 - 01