

ATCO SHAPE the conversation

January 2025

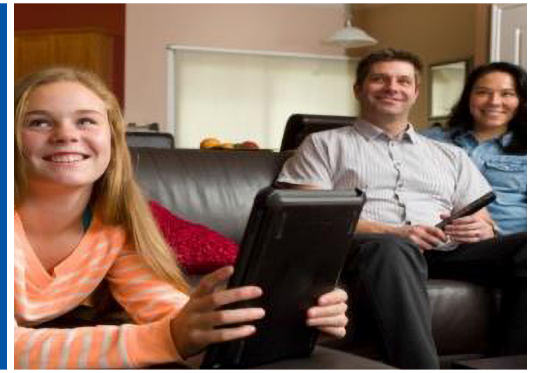

PROJECT NEWSLETTER

OYEN SOLAR EAST CONNECTION TRANSMISSION PROJECT

This newsletter provides you with information about electric transmission facilities being proposed in your area. This package provides important project information and outlines our public consultation process. We invite any comments, questions, or concerns you may have.

The proposed ATCO Electric Ltd. (ATCO) Oyen Solar East Connection Transmission Project (the Project) will be located approximately eight (8) kilometres (km) northwest of Oyen, Alberta and is needed to connect a solar generation facility to the electrical grid.

If approved, the Project will include the construction of approximately nine (9) km of single-circuit 240 kilovolt (kV) transmission line (to be called 9L141) between the existing 959S Lanfine substation and the customer's proposed substation. The Project also requires alterations at the existing 959S Lanfine substation to accommodate the proposed transmission line. Please refer to enclosed materials for further details.

ATCO is seeking your input on how this Project will affect you. If you are in the direct vicinity of the proposed facilities, ATCO will contact you in the coming weeks.

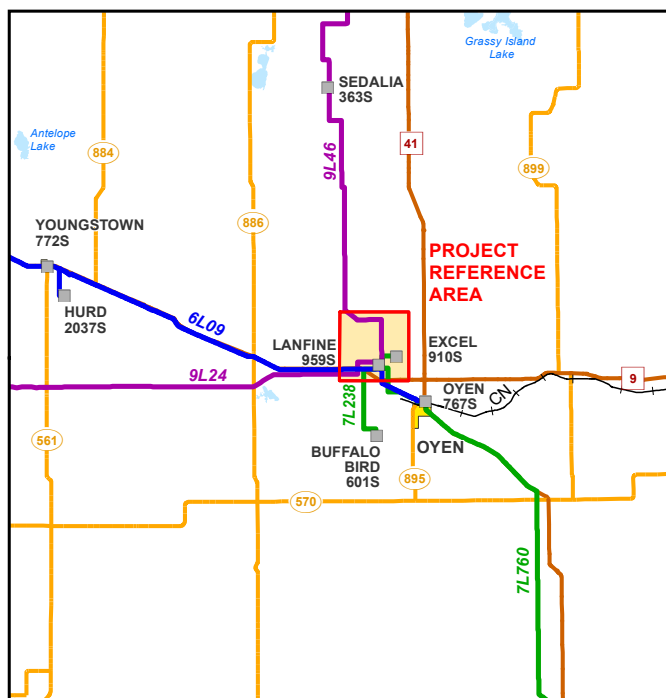

Project Need

The Alberta Electric System Operator (AESO) is an independent, not-for-profit organization responsible for the safe, reliable and economic planning and operation of the provincial transmission grid. For more information about why this project is needed, please refer to the AESO's Need Overview included with this package or visit www.aeso.ca.

If you have any questions or concerns about the need for this project or the proposed transmission development to meet the need, you may contact the AESO directly. You can also make your questions or concerns known to an ATCO representative who will collect your personal information for the purpose of addressing your questions and/ or concerns to the AESO. This process may include disclosure of your personal information to the AESO.

Included in this package:

- Project Fact Sheet
- Proposed Route Mosaic Map
- Proposed Site Layout
- AESO Need Overview
- AUC Brochure: Participating in the AUC's independent review process to consider facility applications
- Reply form and postage paid envelope

LOCAL BENEFITS

Upgrading the transmission system in your area will:

- Improve access to safe, secure and reliable power
- Allow future businesses to connect to Alberta's electric system
- Encourage investment in our province

If you are a local business and would like to be considered for approved vendors list, please contact us toll free at 1-800-668-2248.

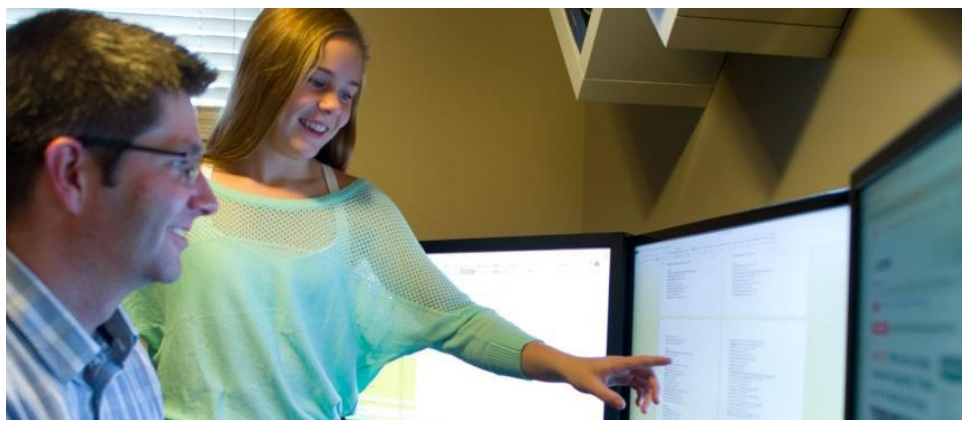

The Process

Our research indicates that you are in the vicinity of the proposed route concept for the Oyen Solar East Connection Transmission Project.

In the coming weeks, if you have an interest in lands located on or beside the proposed route, you will be contacted by an ATCO representative to further discuss the project and to address any questions or concerns you may have. You can also provide feedback and share other information using the enclosed reply form and postage paid envelope.

Consultation with landholders routinely leads to improvements on our projects. We have adjusted project plans as a result of feedback and conversations with landholders.

When consultations have been completed, ATCO will submit a facility application to the Alberta Utilities Commission (AUC) to obtain approval for the construction and operation of the proposed facilities.

Transmission Routes

Prior to consultation with landholders, ATCO considers numerous constraints including:

- Environmentally sensitive areas
- Planned developments
- Construction and engineering constraints
- Existing infrastructure (i.e. other transmission lines, roads, highways, pipelines, telecommunication towers)
- Wetlands
- Quarter and section lines
- Other special consideration (i.e. access roads)

The enclosed map shows the proposed route for this project. Facilities have been located in an effort to minimize impacts to existing land uses and the environment.

THE SCHEDULE

Public consultation begins with sharing information about the project in order to find the best options.

We gather your input. Based on this input and other factors, route option(s) are selected.

ATCO submits an application to the AUC to build proposed facilities.

The AUC reviews the applications in a public process.

If approved, construction of the new facilities begins.

PUBLIC CONSULTATION
a continuous process that occurs throughout the life of the project

The Right-of-Way

The term right-of-way refers to the area a transmission line uses including areas on either side of the line. Rights-of-way must have a minimum width to ensure safety and ongoing access for maintenance.

For safety reasons, some general restrictions on the use of the land in direct vicinity of the transmission line may apply. These include setbacks for development.

Details including width and position of the right-of-way will depend on the type and size of the required structure, existing land use, surrounding features and other factors.

The right-of-way will follow property boundaries, if feasible, and in some situations, will follow existing features like a road, pipeline or another powerline.

The typical width of the right-of-way for the proposed 9L141 transmission line is 34 metres.

Once a proposed route has been submitted to the AUC, ATCO begins coordinating agreements with the landholders to acquire right-of-way. Once a right-of-way is constructed, landholders continue to use the right-of-way subject to the terms of agreements made between the landholder and ATCO.



Access Trails and Temporary Workspace

Access trails may be required in areas where terrain conditions or the presence of wetlands make driving along the right-of-way impractical. In some situations, access trails will be temporary. Permanent access trails may be needed for ongoing maintenance in some areas.

In addition, temporary workspace may be required along the edge of the right-of-way and in other selected locations. The exact location of temporary workspaces has yet to be determined. Arrangements for temporary workspace will be discussed and negotiated with landholders individually.

Project notification

Consultation begins

Application filed with the Alberta Utilities Commission (AUC)

Facilities completed and operating

JANUARY 2025

JANUARY 2025

JULY 2025

OCTOBER 2026
If approval is granted,
construction begins

MARCH 2027

CONTACT INFORMATION

Your comments and concerns are important to us. Please contact us if you would like to learn more about this project or if you would like to share information with us.

- Call us toll free at: 1-855-420-5775 or
- Use the enclosed reply form and postage-paid envelop to share feedback or
- Contact the planner directly:

Thomas Milligan

Land Planning
ATCO Electric Ltd.
10035-105 Street
Edmonton, AB T5J 1C8

Email: consultation@atcoelectric.com
Website: <https://electric.atco.com/en-ca/community/projects/oyen-solar-east-connection-transmission-project.html>

Alberta Electric System Operator (AESO)

Phone: 1-888-866-2959
Email: stakeholder.relations@aesoc.ca
Website: www.aesoc.ca

Alberta Utilities Commission (AUC)

Phone: 780-427-4903
(For toll-free, dial 310-0000 first)
Email: consumer-relations@auc.ab.ca
Website: www.auc.ab.ca

ATCO



Approval Process

Alberta's electrical system is regulated by the AUC, an independent agency of the province that ensures the fair and responsible delivery of utility services. Before ATCO can begin construction on a project, the AUC must approve the facilities application, which includes details such as location of electric transmission facilities and proposed alterations. For more information about how you can participate in the AUC approval process, please refer to the enclosed AUC brochure, *Participating in the AUC's independent review process to consider facility applications*.

Next Steps

The consultation process for this project is ongoing. Please let us know if you have any questions, concerns or suggestions regarding this Project. You can provide feedback and share other information by contacting us (toll free) at **1-855-420-5775** or by email at **consultation@atcoelectric.com**.

January 2025

OYEN SOLAR EAST CONNECTION TRANSMISSION PROJECT

The technical details of facilities associated with the Oyen Solar East Connection Transmission Project are described in this fact sheet. Designs may vary as plans are finalized.



Existing 959S Lanfine Substation

The Project will require alterations to the existing substation to accommodate the proposed transmission line.

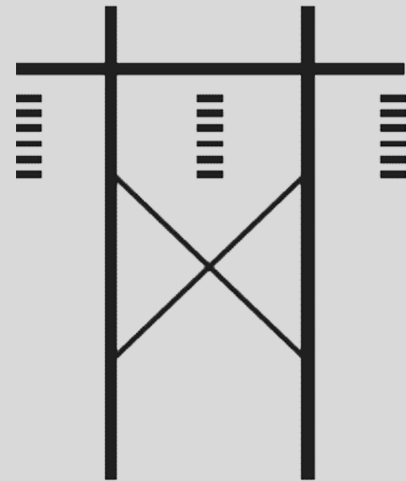

New 240 kV Transmission Line 9L141

Approximately nine km of new single-circuit 240 kV transmission line (to be called 9L141).

THE DETAILS

If approved, the work will include the installation of the following new equipment (please refer to the back of this fact sheet for definitions):

- Two (2) 240 kV circuit breakers
- Associated switches and equipment

The new equipment will be installed entirely within the existing 959S Lanfine substation site (please see enclosed site layout).

THE DETAILS

If approved, the new single-circuit 240 kV transmission line 9L141 will consist of:

- Three sets of bundled conductor wires
- Wood pole H-Frame structures
- One (1) overhead shield wire
- One (1) optical ground wire
- One (1) Motor Operated Disconnect (MOD)

Transmission line 9L141 will connect the existing 959S Lanfine substation to the customers proposed substation.

What It Will Look Like

If approved by the AUC, the new 240 kV transmission line will be built with wood H-frame structures similar to the one shown here.

Structures will be single-circuit. This means they will have three sets of bundled conductor wires strung across them, one overhead shield wire and one optical ground wire at the top of the structure. The typical distance between structures will be approximately 160 to 200 metres (m).

Non-typical structures may be taller in height or have wider bases.

Guy wires and anchors may be required where the line ends, bends, goes around corners or avoids obstacles. In all cases, minimum clearance will meet or exceed provincial safety regulations.

Note: Details may change as the project develops and designs are finalized.

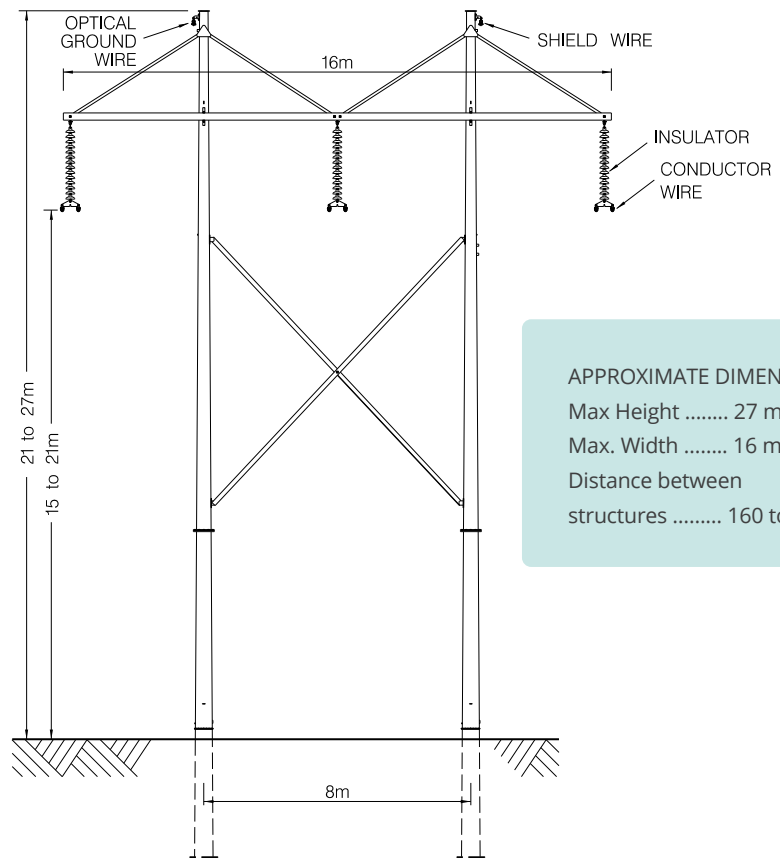

APPROXIMATE DIMENSIONS
 Max Height 27 m
 Max. Width 16 m
 Distance between
 structures 160 to 200 m

Typical right-of-way for this project – 34 metres

Rights-of-way are cleared of trees, bush and debris to allow access for construction and ongoing maintenance.

Definitions

Capacitor: A device that stores electrical energy by accumulating electrical charges on two closely spaced surfaces that are insulated from each other.

Circuit: A circuit is a group of wires electricity flows through. ATCO's transmission lines can be single or double circuit. A single-circuit line has three wires and a double-circuit line has six. A transmission line may also have one or two shield wires on the top of the structures to protect the line from lightning.

Circuit Breaker: A circuit breaker is an automatic switch that is designed to protect an electrical circuit from overloading by shutting off the flow of electricity.

Consultation: A consultation is a meeting where advice, information and views are exchanged.

Kilovolt (kV): A kilovolt is equal to one thousand volts. This unit of measurement is most commonly used when describing transmission and distribution lines.

Distribution and transmission lines in Alberta carry between 4-kV (4,000 volts) and 500-kV (500,000 volts).

Right-of-way: A right-of-way is the use of a strip of land acquired for the construction and operation of a transmission line. The term right-of-way is also used to refer to the physical space a transmission line encompasses including areas on either side of the line.

Transformer: An electrical device that increases or decreases the voltage of electricity in an electrical substation.



10035-105 Street, Edmonton, Alberta, T5J 1C8

SHAPE THE CONVERSATION

OYEN SOLAR EAST CONNECTION TRANSMISSION PROJECT

REPLY FORM

CONTACT INFORMATION

Date (DD/MM/YYYY): _____

First Name: _____

Last Name: _____

Company/Organization Name (if applicable):

Mailing Address: _____

Home Phone: _____

Cell Phone: _____

Business Phone: _____

Email: _____

Please help us identify new contacts

You were contacted about this project because ATCO identified you or your company/organization as having a land interest in the vicinity of the project. Is there anyone else associated with your property, such as other owners, renters or occupants, who we should also contact? If so, please provide the name(s), contact information and their land interest.

☐ I would like to receive all future correspondence about this project by Email (If this is your preference, please check the box)

AN IMPORTANT MESSAGE ABOUT PRIVACY: *The information on this form is being collected to identify concerns with proposed changes to and/or the siting of power transmission facilities, and to comply with the Alberta Utilities Commission (AUC) rules regarding the submission of transmission facilities applications. This information may be provided to electric facility owners, Alberta's Land & Property Rights Tribunal, and the Alberta Electric System Operator. Your comments and personal information may also be publicly accessible through the AUC website, should it be submitted to the AUC as part of a transmission facility application – subject to Alberta's Freedom of Information and Protection of Privacy Act. **If you wish to keep your information confidential, you must make a request to the AUC (403-592-4376).** If you have questions or concerns about your information or how it may be used or disclosed as part of this process, please contact us (see contact information below).*

Please let us know by checking a box below if either statement applies to you:

☐ I do not have concerns with the Project based on the information provided

☐ I have concerns with the Project based on the information provided

Please share any comments or concerns that you have about the Project: